



See Different.

Manual Lens Firmware Update Instruction

1. Firstly please ensure the battery capacity is more than 50%, copy the 'LENS_FW.lin' to SD card root directory. Then insert the SD card into the camera.



名称	修改日期	类型	大小
DCIM	2017/3/27 14:14	文件夹	
XIAOYI	2016/8/22 21:04	文件夹	
firmware.bin	2017/1/24 18:56	BIN 文件	10,152 KB
LENS_FW.lin	2017/4/13 9:45	LIN 文件	257 KB

2. Restart the camera, slide right on the Live View screen and switch to the 'MENU SETTING' screen, then slide up twice and click the 'Firmware Info' icon, as shown below:

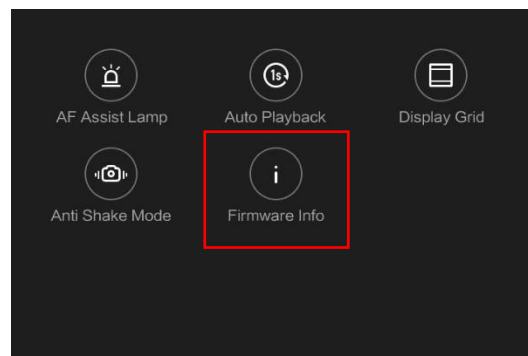

3. Click the 'Firmware Info' icon , you can check the current firmware information as shown below:



4. Press the 'Q' and 'PLAYBACK' buttons on the 'Firmware Info' screen **at the same time** , then switch to the Factory Settings screen.



See Different.



5. Select the 'Upgrade Lens Firmware' item, then it will pop up a dialog and select 'Yes', it will be successful after 12 seconds and will reboot automatically.

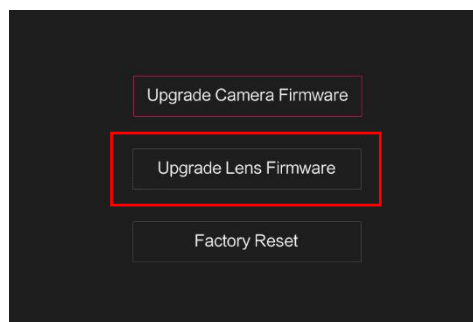

6, After restarting the camera, check the Lens Firmware Info is the latest version.

